



GENERAL INFORMATION:

The **reinforcement bar** is designed to increase the structural rigidity of the original crash guard and frame area of the motorcycle. It provides added protection for critical engine and chassis components in the event of a fall or impact, and is especially useful during off-road riding or long-distance touring.

This product is made from high-strength steel tubing (25 mm diameter) and mounts securely to the frame and the original crash bar at two points on each side.

TOOLS & PREPARATION:

- Torque wrench (capable of 100 Nm)
- Torx driver (for M6 bolts)
- Metric spanners/sockets (M6 and M12)
- Degreaser and clean cloth
- Scissors (to cut protection film)
- Medium-strength thread-locking compound

Before you begin:

- Park the motorcycle on a stable, level surface.
- Ensure the engine and exhaust are cool.
- Check that all components from the kit are present.
- Identify left and right side reinforcement bars.

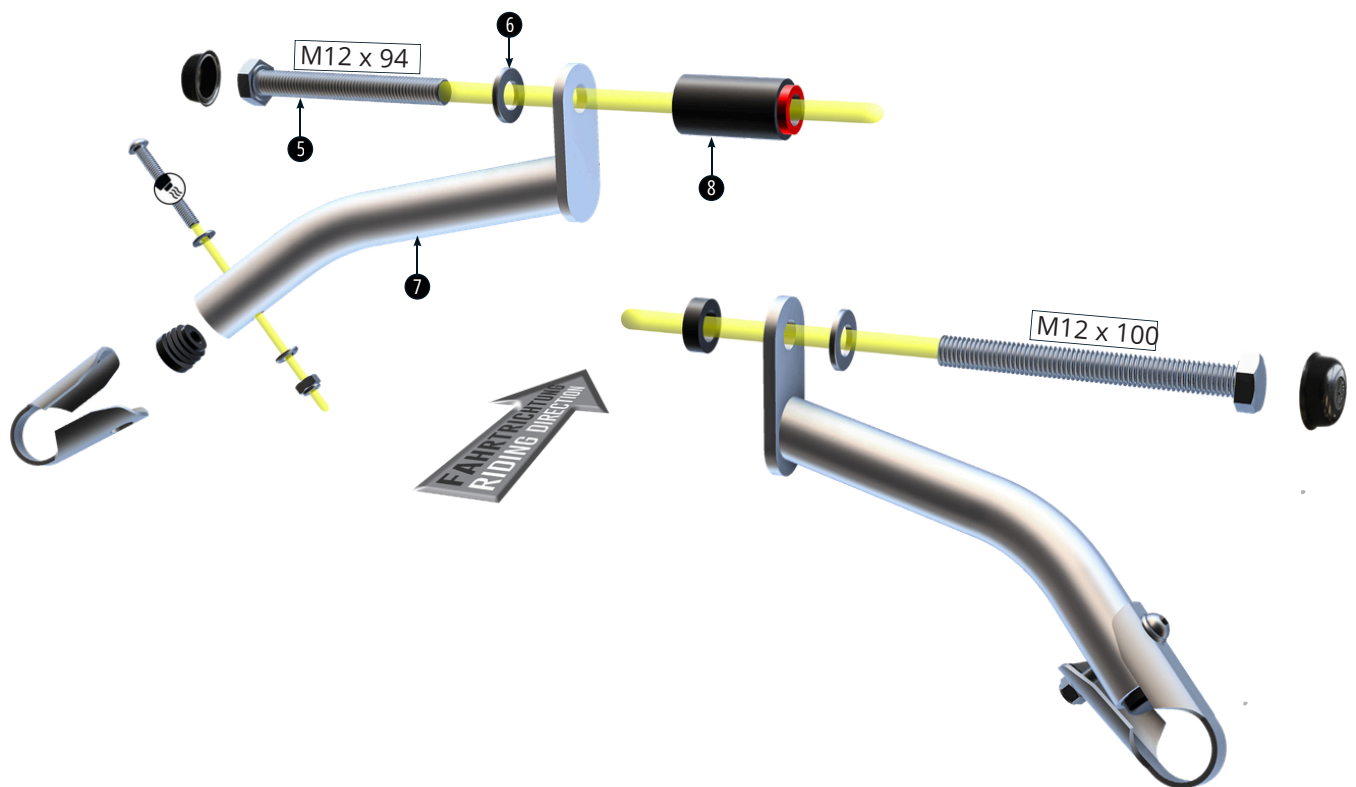

STEP-BY-STEP INSTALLATION INSTRUCTIONS :**Step 1: Prepare Mounting Areas**

1. Thoroughly clean and degrease the areas where the reinforcement bar will make contact.
2. Apply the supplied paint protection film to the marked areas. This prevents scratches and paint damage during installation and use.

Step 2: Assemble Components Loosely

1. Insert the supplied sleeves into the ends of the reinforcement bar tube where indicated.
2. Attach the pipe clamp and lamellar plug to the section that connects to the original crash guard.
3. Insert the M6 bolts, washers, and nuts but leave them finger-tight for now.

Step 3: Align the Reinforcement Bar

1. Position the reinforcement bar so that it aligns naturally with the mounting points on the frame and the original guard.
2. Insert the M12 bolts with washers and clamp caps into the main mounting points. Do not fully tighten yet.

Step 4: Final Fitment and Clearance Check

1. With all hardware loosely installed, adjust the reinforcement bar so that it fits without force or tension.
2. Check for adequate clearance from wiring, hoses, fairings, and other components.

Step 5: Secure the Hardware

1. Remove one bolt at a time, apply medium-strength thread-locking compound, and reinstall.
2. Tighten the M6 clamp bolts securely, ensuring they are snug but not over-tightened.
3. Torque the M12 bolts to 100 Nm using a torque wrench.

Step 6: Repeat for Opposite Side

1. Follow the same steps for the reinforcement bar on the other side of the motorcycle.

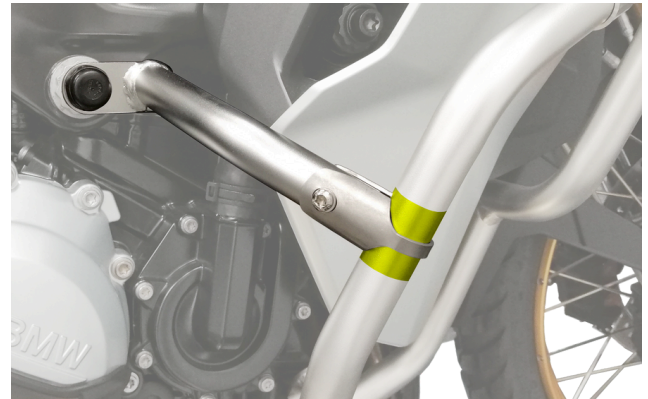
RHS**LHS**

Net Content

No	Parts	Qty	Nm
1	Reinforcement Bar bend pipe	2	
2	Reinforcement Bar Clamps	2	
3	Screw M12 x 100	1	100
4	Screw M12 x 90	1	100
5	BUSH 39 x 27 mm	1	
6	BUSH 5 x 22 mm	1	
7	M8 x 40 with locknut	2	

ATTENTION:

- Always tighten M12 bolts to 100 Nm torque.
- Apply medium-strength thread-locking compound on all bolts to prevent loosening.
- Ensure the paint protection film is applied after degreasing to avoid paint damage.
- Insert all sleeves into their correct positions — never omit them.
- Do not force the bar into position. If alignment is off, loosen, realign, and try again.
- Recheck all fasteners after the first 50–100 km of riding and periodically thereafter.
- Inspect regularly for signs of loosening, corrosion, or wear.
- If you are unsure about installation, seek assistance from a professional technician.